

1 SITE LOCATION MAP
1: 1000

Copyright and ownership of this drawing is vested in RKD Architects, whose prior written consent is required for its use, reproduction or for publication to any third party. All rights reserved by the law of copyright and by international copyright conventions are reserved to RKD Architects and may be protected by court proceedings for damages and/or injunctions and costs. RKD Architects' Quality Management Systems are certified to ISO 9001:2015.

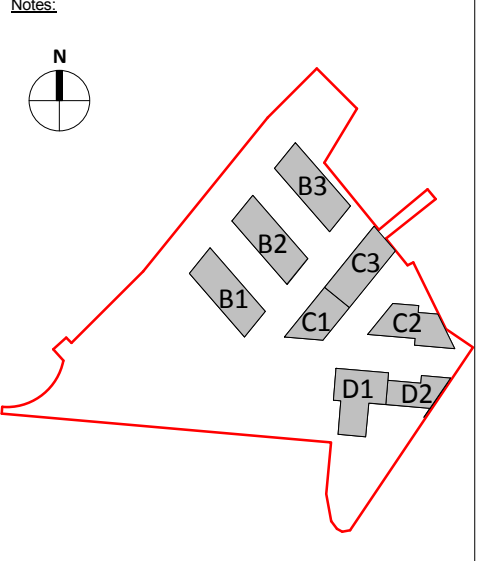

ORDNANCE SURVEY IRELAND
LICENSE NO.
AR 00028-19

OS FOLIO NO.'S:
3264-01 - Rev 30/03/2016
3264-02 - Rev 30/03/2016
3198-21 - Rev 30/03/2016
3198-22 - Rev 30/03/2016

ITM CENTRE PT. COORDS
716804, 734964

Notes:

- SITE BOUNDARY**

All levels shown are to the Irish Transverse Mercator (ITM) and are displayed in meters (m). All levels relate to Malin Head datum. All dimensions are given in millimeters (mm).

LOCATION OF SITE NOTICE

SITE AREA: 28,840 m²
7.127 Acres
2.884 Hectare

Rev.	Date	Description
A	OCT 2019	Issued for Planning Application Submission

STATUS: PLANNING

PROJECT: THE CONNOLLY QUARTER

PROJECT ADDRESS: Lands to the Rear of Connolly Station, Dublin 1

DWG TITLE: SITE LOCATION MAP

DWG NO: 18135-RKD-00-00-DR-A-1000

REV.	PROJECT NO.	SCALE
A	18135	As indicated

DATE	DRN	JB	CHK	SG
JUN 2019				

